

LC Fiber Optic Loopback Adapter (50/125)

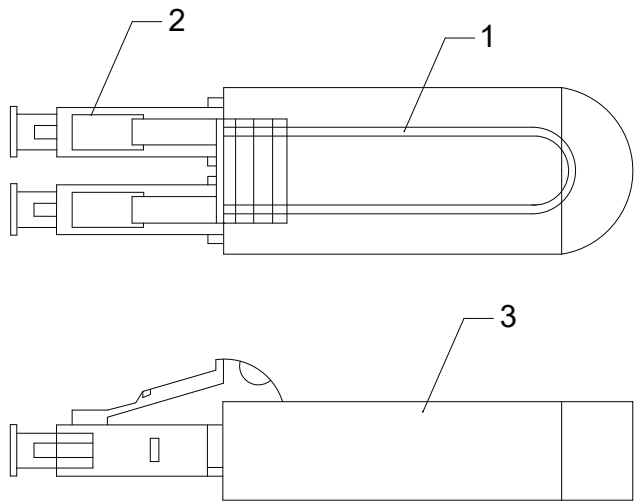

The Networx® LC Multimode OM2 Loopback Adapter is a dependable and compact solution for testing fiber optic systems. It enables quick diagnostics and verification of network transceivers by creating a complete signal path, making it indispensable for troubleshooting and validation tasks.

Engineered with high-quality Corning glass and precision-molded connectors, this loopback adapter provides repeatable, low-loss performance in both field and lab environments.

Key Features

- **Connector Type:** LC Male to LC Male
- **Core Size:** 50/125 μm (OM2 Multimode)
- **Insertion Loss:** <0.25dB (Typical), $\leq 0.50\text{dB}$ (Max)
- **Operating Temperature:** -40°C to +85°C
- **Length:** 2-inch compact design
- **Boot Size:** 0.9mm
- **Color:** Ivory for OM2 identification
- **Warranty:** Lifetime Manufacturer Warranty

Applications

- Diagnostic loopback testing for Multimode LC transceivers
- Network troubleshooting and validation
- Field installations and lab environments
- Suitable for telecom, data centers, and enterprise fiber systems.

3 Black Plastic Housing

2 LC/UPC MM Duplex 2.0mm Connector (Beige Housing)

1 OD:250 μm , Multimode 50/125 OM2, Corning Simplex, Bare Core Fiber Color:Transparent

