

1

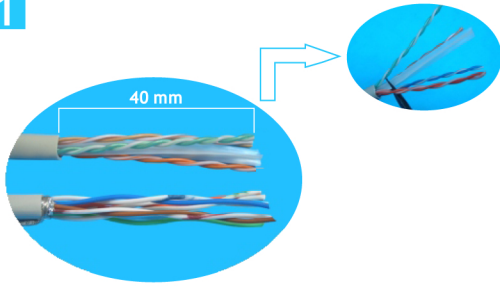

Strip approximately 40mm of the cable jacket, and cut off the plastic cross.

Attn: Suitable for 22~26AWG Solid & Stranded Wire

2

Punchdown Sequences

T568A

Pin 5 White/Blue
Pin 4 Blue

Pin 1 White/Green
Pin 2 Green

Pin 3 White/Orange
Pin 6 Orange

Pin 7 White/Brown
Pin 8 Brown

T568B

Pin 5 White/Blue
Pin 4 Blue

Pin 1 White/Orange
Pin 2 Orange

Pin 3 White/Green
Pin 6 Green

Pin 7 White/Brown
Pin 8 Brown

Unshielded Type

3

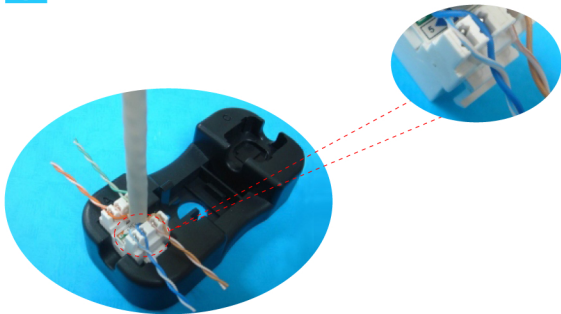

Follow the wiring sticker to place the wires into IDC slot. Keep the pairs twisted as possible as you can.

4



Punch the wires with 110 or Krone impact tool and cut off the surplus wires.

5

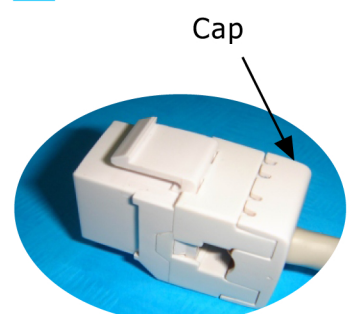

Snap in the IDC cap to fix the wires, and finish the installation.

Shielded Type

3

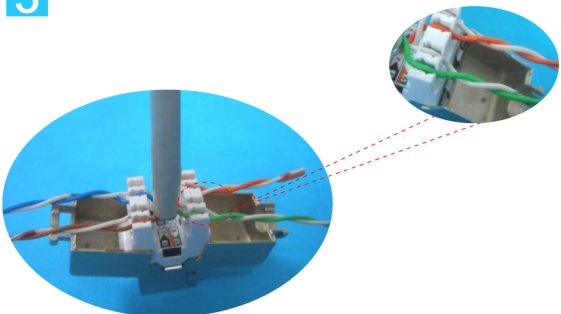

Follow the wiring sticker to place the wires into IDC slot. Keep the pairs twisted as possible as you can.

4

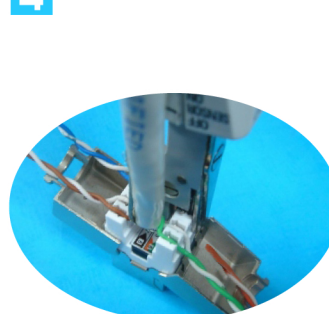

Punch the wires with 110 or Krone impact tool and cut off the surplus wires.

5

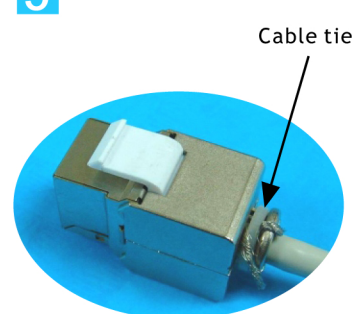

Tie up the cable by cable tie, and finish the installation.